

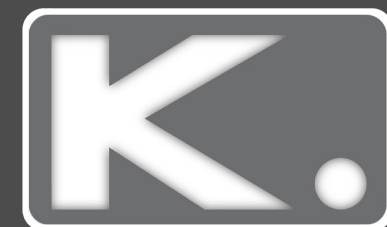

**3 Bed
House - Detached
located in Brighton**

£750,000



Tivoli Road, Brighton

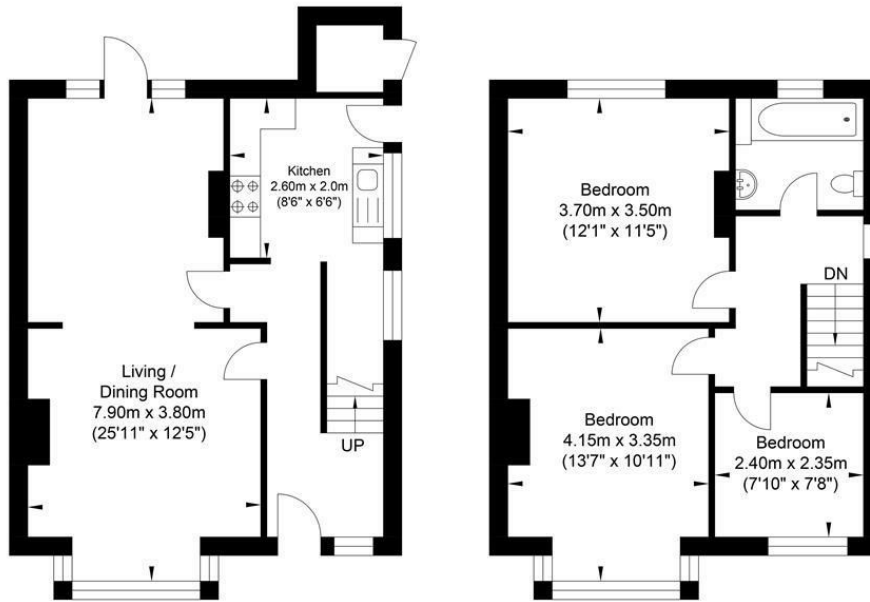

Ground Floor
Approximate Floor Area
476.62 sq ft
(44.28 sq m)

First Floor
Approximate Floor Area
462.52 sq ft
(42.97 sq m)

Approximate Gross Internal Area = 87.25 sq m / 939.15 sq ft
Illustration for identification purposes only, measurements are approximate, not to scale.

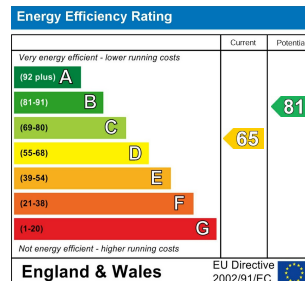

DIRECTIONS

CONTACT

Kendrick Property Services - Brighton
10-12 Lewes Road
Brighton
East Sussex
BN2 3HP

E:
sales@kendrickpropertyservices.co.uk
T: 01273 600162
www.kendrickpropertyservices.co.uk

